

SURFACE-MOUNT HIGH CURRENT INDUCTORS

SPI0605HC SERIES



FEATURES:

- Current up to 6A
- Flat-top for Pick & Place
- Very low DC Resistance
- Low profile

APPLICATIONS:

- Ideal for High Current, Low Voltage DC – DC Converters
- Designed for 3.3V Microprocessor

STANDARD SPECIFICATION:

Part Number SPI0605HC-	L (μ H) \pm 20%	IRMS (A)max	I SAT (A)max	DCR (Ω) max.
R47M	0.47	6.0	7.7	0.0097
1R0M	1.0	4.4	5.3	0.0177
1R5M	1.5	4.2	4.5	0.0200
2R2M	2.2	3.1	3.5	0.0363
3R3M	3.3	2.9	3.0	0.0428
4R7M	4.7	2.2	2.6	0.0544
6R8M	6.8	1.7	2.2	0.0897
100M	10.0	1.5	1.9	0.1107
150M	15.0	1.2	1.5	0.1747
220M	22.0	1.0	1.2	0.2541
330M	33.0	0.82	0.99	0.3670
470M	47.0	0.72	0.87	0.4740
680M	68.0	0.58	0.67	0.7320
101M	100.0	0.47	0.53	1.1090

PHYSICAL CHARACTERISTICS Dimensions(mm):

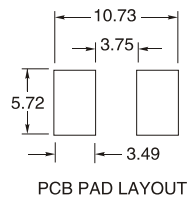
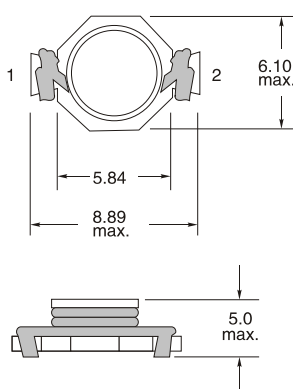

Winding



- Notes: (1)Open Circuit Inductance Test Parameters: 100KHz,.250Vrms,0.0Adc.
 (2)RMS current for an approximate Δ T of 40°C. at an ambient temperaturer of 85°C.
 (3)Peak current for approximately 30% rolloff.
 (4)DCR limits 20°C.
 (5)Operating Temperature:-40°C to + 85°C
 (6)Tape & Reel is Standard Bulk Packaging Available for Smaller Quantities
 All specifications subject to change without notice.